

Engineered to allow adjustment under load of mechanical and HVAC services, primarily heating/cooling panels or units. Allows for accurate and finite suspension of services.

FEATURES / BENEFITS

- **Quick** – up to 6 times faster than traditional suspension systems
- **Safe** – 35 mm of finite adjustment using integral adjustment pillar and M8 thread
- **Easy** – Designed for adjustment of building services under load
- **Secure** – button acts as a locking screw and indicator clearly highlights the wire is locked in position for ultimate security
- **Strong** – up to 55 kg with 5:1 SWL



INSTALLATION & ADJUSTMENT

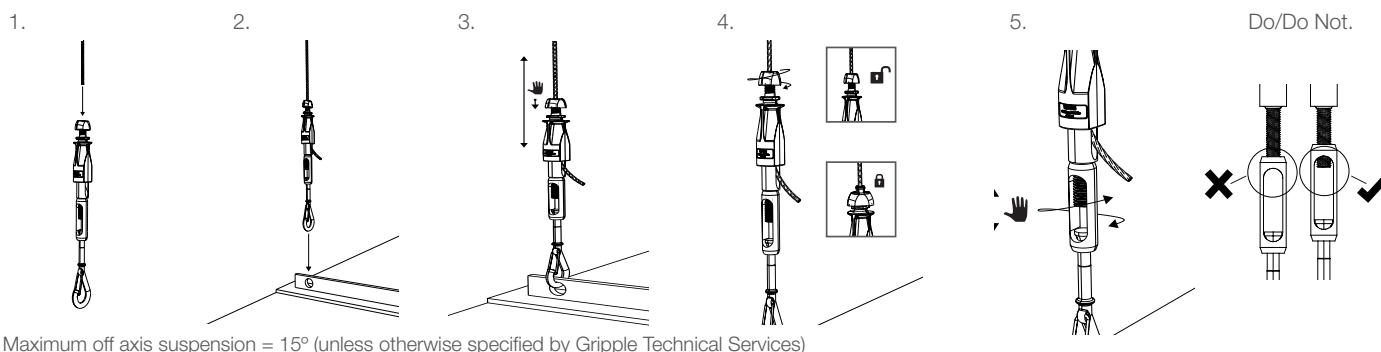

SPECIFICATION

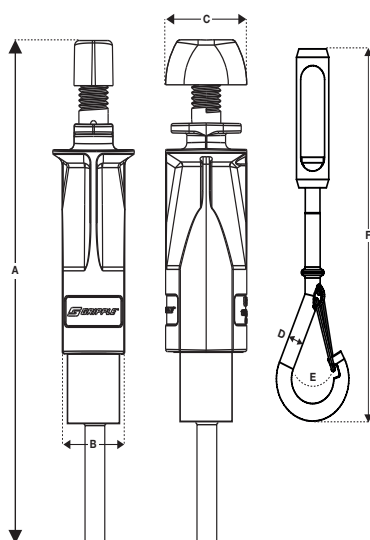

No. 2	Dimension	A	B	C	D	E	F
	mm	55	17	20	7	8	134

AVAILABLE END FIXINGS



For more options on available end fixings please contact us or visit www.gripple.com

SUBMITTAL INFORMATION

Load Rating:

No. 2 - 55 kg @ 5:1

Material:

Housing – Type ZA2 Zinc

Carriage – Acetal Copolymer

Wedge – Sintered steel hardened to min. 56 Rockwell C

Button – Acetal Copolymer

Calibra adaptor (Thread - Turnbuckle -

Crimped Pin - Snap Hook) – Mild Steel

(Type EN1A) - Bright Zinc Plated